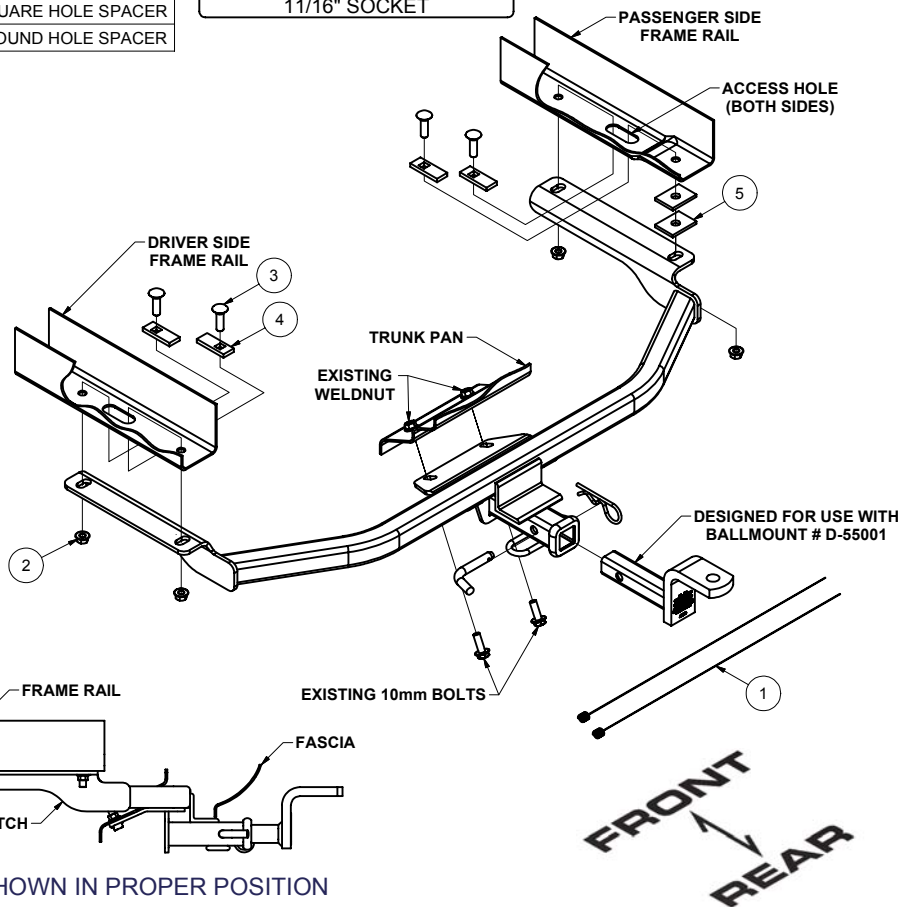
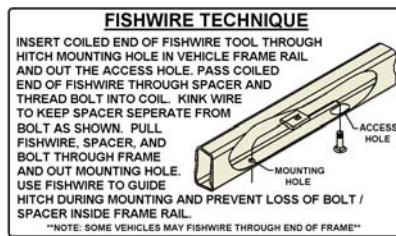
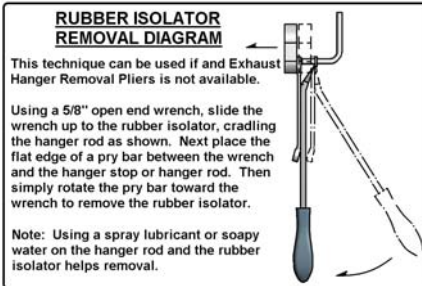

11831**SAAB 9-5****6/04/2009****GROSS LOAD CAPACITY WHEN USED AS A WEIGHT CARRYING HITCH: 2,500 LBS. TRAILER WEIGHT & 200 LBS. TONGUE WEIGHT.*******DO NOT EXCEED VEHICLE MANUFACTURER'S RECOMMENDED TOWING CAPACITY.*******WARNING: ALL NON-TRAILER LOADS APPLIED TO THIS PRODUCT MUST BE SUPPORTED BY AUXILIARY STABILIZING STRAPS.****** FAILURE TO PROPERLY SUPPORT NON-TRAILER LOADS WILL VOID PRODUCT WARRANTY******HAVING INSTALLATION QUESTIONS? CALL TECHNICAL SUPPORT AT 1-800-798-0813**

Parts List				
ITEM	QTY	PART NUMBER	DESCRIPTION	
1	2	7_16 FISHWIRE	7/16" FISHWIRE	
2	4	7/16-14	HEX FLANGE NUT	
3	4	7/16-14 x 1 1/2	CARRIAGE BOLT	
4	4	CM-SP2	.250 x .88 x 2.25" SQUARE HOLE SPACER	
5	2	CM-SP32	.188 x 1.50 x 2.00" ROUND HOLE SPACER	

TOOLS REQUIRED
RATCHET
TORQUE WRENCH
14mm SOCKET
16mm SOCKET
11/16" SOCKET

HITCH WEIGHT: 28 LBS.**INSTALL TIME**PROFESSIONAL: 20 MINUTESNOVICE (DIY): 45 MINUTES**INSTALL NOTES:**

- LOWER EXHAUST
- NO DRILLING REQUIRED

HITCH SHOWN IN PROPER POSITION

INSTALLATION STEPS

1. Remove tow loop and fasteners. Return tow loop and upper fastener to owner. Retain lower tow loop bolts, they will be used later in the installation.
NOTE: Upper most hole will not be used and should be sealed shut with silicon caulk.
2. Lower exhaust for ease of installation. Support exhaust as needed to prevent damage.
3. Fishwire 7/16" carriage bolts and SP2 spacers through access holes in frame, as shown. (SEE FISHWIRE TECHNIQUES)
4. Position (2) SP32 spacers over the rear most hole in the passenger side plate. Raise hitch into position and loosely secure with 7/16" flange nuts.
5. Secure center mounting plate of hitch with the existing 10mm bolts into the trunk pan weldnuts.
6. Torque all 7/16" fasteners to 50 ft-lbs. Torque all 10mm fasteners to 40 ft-lbs.
7. Reinstall exhaust.

PERIODICALLY CHECK THIS RECEIVER HITCH TO ENSURE THAT ALL FASTENERS ARE TIGHT AND THAT ALL STRUCTURAL COMPONENTS ARE SOUND.

Curt Manufacturing Inc., warrants this product to be free of defects in material and/or workmanship at the time of retail purchase by the original purchaser. If the product is found to be defective, Curt Manufacturing Inc., may repair or replace the product, at their option, when the product is returned, prepaid, with proof of purchase. Alteration to, misuse of, or improper installation of this product voids the warranty. Curt Manufacturing Inc.'s liability is limited to repair or replacement of products found to be defective, and specifically excludes liability for incidental or consequential loss or damage.