

11130

05-06 Mini Cooper S Hardtop without Rear Fog Light
05-08 Mini Cooper S Convertible without Rear Fog Light
07-09 Mini Cooper S Hardtop
2009 Mini Cooper S Convertible

9/23/2009

Page 1 of 6

GROSS LOAD CAPACITY WHEN USED AS A WEIGHT CARRYING HITCH: 2,000 LBS. TRAILER WEIGHT & 200 LBS. TONGUE WEIGHT.

DO NOT EXCEED VEHICLE MANUFACTURER'S RECOMMENDED TOWING CAPACITY.

WARNING: ALL NON-TRAILER LOADS APPLIED TO THIS PRODUCT MUST BE SUPPORTED BY AUXILIARY STABILIZING STRAPS.

** FAILURE TO PROPERLY SUPPORT NON-TRAILER LOADS WILL VOID PRODUCT WARRANTY**

HAVING INSTALLATION QUESTIONS? CALL TECHNICAL SUPPORT AT 1-800-798-0813

Parts List			
ITEM	QTY	PART NUMBER	DESCRIPTION
1	8	3/8"	CONICAL TOOTHED WASHER

TOOLS REQUIRED	
#2 PHILLIPS SCREWDRIVER	
#2 STUBBY SCREWDRIVER	
8mm SOCKET	
13mm SOCKET	
RATCHET	
12" EXTENSION	
TORQUE WRENCH	

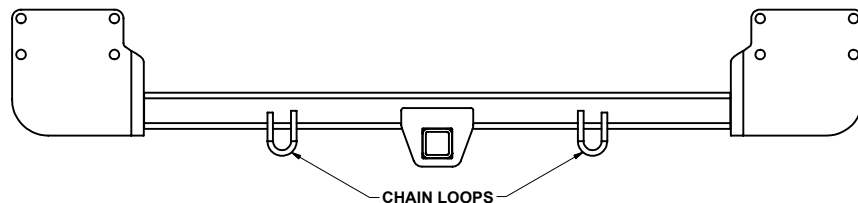
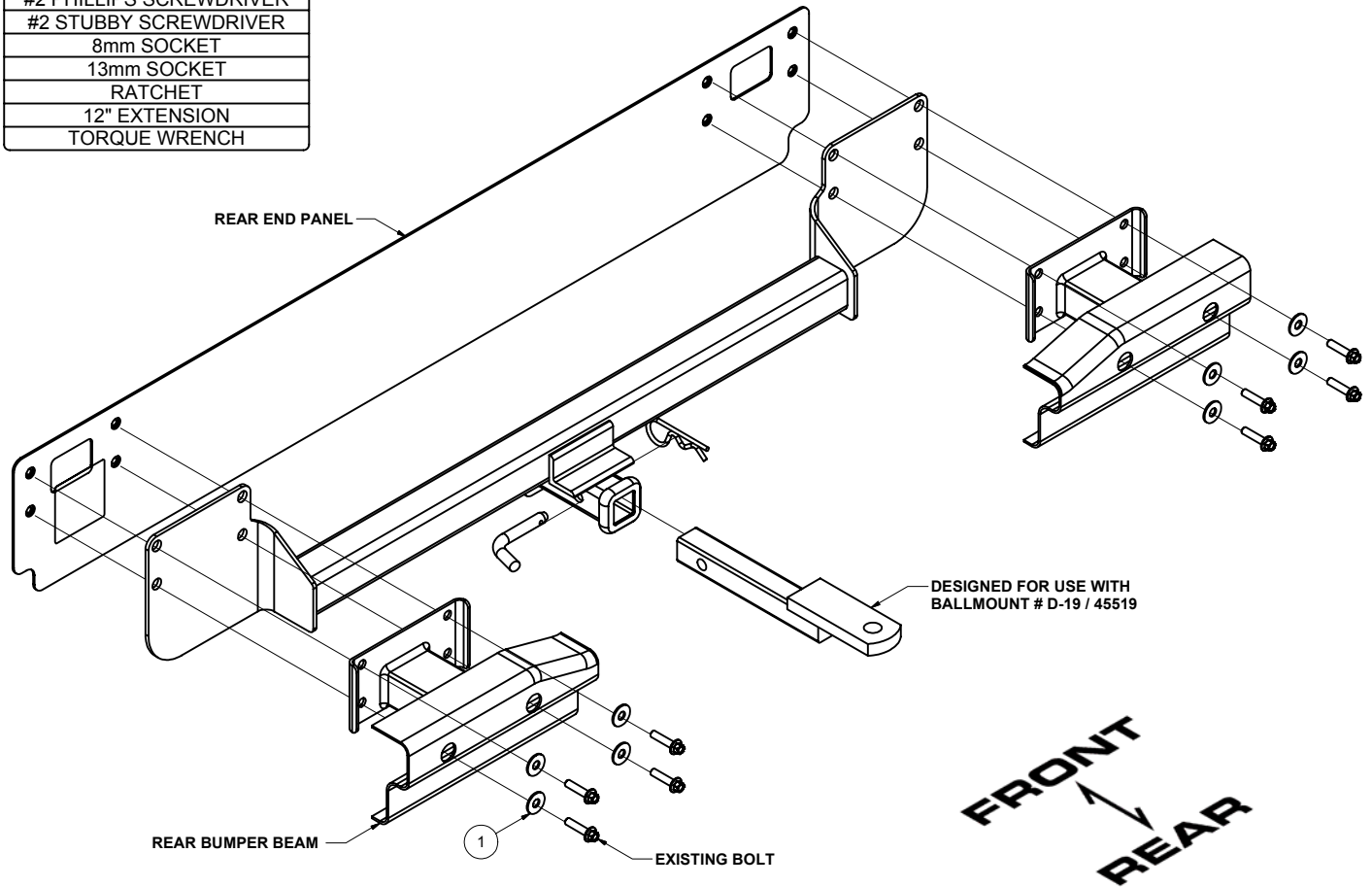

HITCH WEIGHT: 29 LBS.

INSTALL TIME

PROFESSIONAL: 60 MINUTES

NOVICE (DIY): 120 MINUTES

INSTALL NOTES:

- REMOVE BUMPER COVER
- MAY REQUIRE TRIMMING
- MAY REQUIRE HEAT SHIELD MODIFICATION

NOTE: Longer safety chains may be required to reach the chain loops. Verify that your safety chains are long enough to clear lower valance while turning before towing.

PERIODICALLY CHECK THIS RECEIVER HITCH TO ENSURE THAT ALL FASTENERS ARE TIGHT AND THAT ALL STRUCTURAL COMPONENTS ARE SOUND.

Curt Manufacturing Inc., warrants this product to be free of defects in material and/or workmanship at the time of retail purchase by the original purchaser. If the product is found to be defective, Curt Manufacturing Inc., may repair or replace the product, at their option, when the product is returned, prepaid, with proof of purchase. Alteration to, misuse of, or improper installation of this product voids the warranty. Curt Manufacturing Inc.'s liability is limited to repair or replacement of products found to be defective, and specifically excludes liability for incidental or consequential loss or damage.

11130

05-06 Mini Cooper S Hardtop without Rear Fog Light
05-08 Mini Cooper S Convertible without Rear Fog Light
07-09 Mini Cooper S Hardtop
2009 Mini Cooper S Convertible

Page 2 of 6

GROSS LOAD CAPACITY WHEN USED AS A WEIGHT CARRYING HITCH: 2,000 LBS. TRAILER WEIGHT & 200 LBS. TONGUE WEIGHT.

*****DO NOT EXCEED VEHICLE MANUFACTURER'S RECOMMENDED TOWING CAPACITY.*****

WARNING: ALL NON-TRAILER LOADS APPLIED TO THIS PRODUCT MUST BE SUPPORTED BY AUXILIARY STABILIZING STRAPS.

**** FAILURE TO PROPERLY SUPPORT NON-TRAILER LOADS WILL VOID PRODUCT WARRANTY****

HAVING INSTALLATION QUESTIONS? CALL TECHNICAL SUPPORT AT 1-800-798-0813

Notes:

- This hitch is not intended for use as a weight distributing hitch.
- This hitch features a removable ball mount.
- Before towing, the hitch pin and retainer clip **MUST** be in place, securing the ball mount to the receiver.

Removing the Bumper Cover:

The stock bumper covers on the Mini Cooper S are attached to the vehicle with (11) fasteners. See Photo 1 for the types of fasteners used.

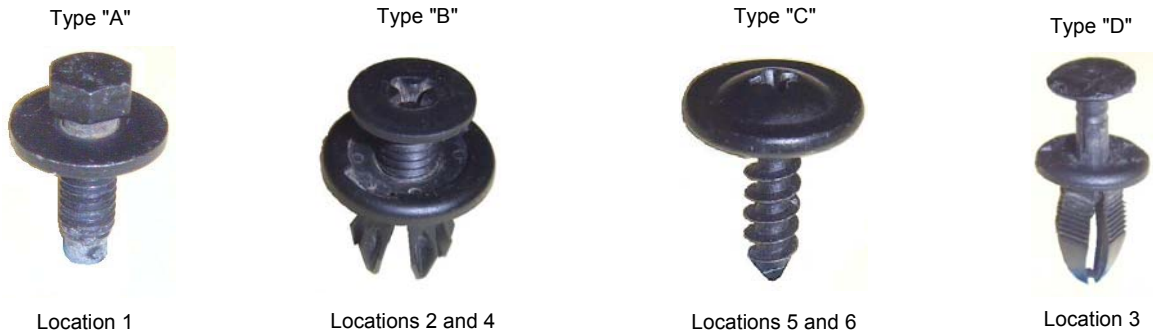

Photo 1: Fastener Types and Locations: "A" is a washer head hex screw, "B" are phillips head push fasteners, "C" are phillips head screws and "D" are push fasteners.



Photo 2: Fastener locations as viewed from inside of the bumper cover. (These fastener locations are present on all models.)

1. Remove the washer head hex screw at the bottom of the bumper cover, near the muffer. (Location 1 in Photo 2)
2. Remove the (4) phillips head push fasteners, (2) at the back of each wheel opening. These are accessed from inside the fender well, behind the rear tire. (Locations 2 and 4 in Photo 2)

PERIODICALLY CHECK THIS RECEIVER HITCH TO ENSURE THAT ALL FASTENERS ARE TIGHT AND THAT ALL STRUCTURAL COMPONENTS ARE SOUND.

Curt Manufacturing Inc., warrants this product to be free of defects in material and/or workmanship at the time of retail purchase by the original purchaser. If the product is found to be defective, Curt Manufacturing Inc., may repair or replace the product, at their option, when the product is returned, prepaid, with proof of purchase. Alteration to, misuse of, or improper installation of this product voids the warranty. Curt Manufacturing Inc.'s liability is limited to repair or replacement of products found to be defective, and specifically excludes liability for incidental or consequential loss or damage.

11130

05-06 Mini Cooper S Hardtop without Rear Fog Light
05-08 Mini Cooper S Convertible without Rear Fog Light
07-09 Mini Cooper S Hardtop
2009 Mini Cooper S Convertible

Page 3 of 6

GROSS LOAD CAPACITY WHEN USED AS A WEIGHT CARRYING HITCH: 2,000 LBS. TRAILER WEIGHT & 200 LBS. TONGUE WEIGHT.

DO NOT EXCEED VEHICLE MANUFACTURER'S RECOMMENDED TOWING CAPACITY.

WARNING: ALL NON-TRAILER LOADS APPLIED TO THIS PRODUCT MUST BE SUPPORTED BY AUXILIARY STABILIZING STRAPS.

** FAILURE TO PROPERLY SUPPORT NON-TRAILER LOADS WILL VOID PRODUCT WARRANTY**

HAVING INSTALLATION QUESTIONS? CALL TECHNICAL SUPPORT AT 1-800-798-0813



Photo 3: Fastener B behind rear wheel well liner.

3. Remove the (2) plastic push fasteners that hold the rear wheel arch to the rear bumper cover, one each side. They are behind the inner fender liner, at location 3 in Photos 2 and 3. To remove these fasteners, push the inner piece down from the top until enough of the head is available from the bottom to pry it the rest of the way out. Remove both pieces.



Photo 4: Fastener C behind wheel moulding.

4. The next two screws are hidden under the fender flair that is attached to the body, as shown in Photo 4. To free the fender flair, push the bumper towards the front of the vehicle while pushing the fender flair towards the rear of the vehicle. To free the top clip, pry the arch away from the bumper.
5. Remove the hidden screw at position 5. Disconnect the side marker light. Repeat for the other side.

PERIODICALLY CHECK THIS RECEIVER HITCH TO ENSURE THAT ALL FASTENERS ARE TIGHT AND THAT ALL STRUCTURAL COMPONENTS ARE SOUND.

Curt Manufacturing Inc., warrants this product to be free of defects in material and/or workmanship at the time of retail purchase by the original purchaser. If the product is found to be defective, Curt Manufacturing Inc., may repair or replace the product, at their option, when the product is returned, prepaid, with proof of purchase. Alteration to, misuse of, or improper installation of this product voids the warranty. Curt Manufacturing Inc.'s liability is limited to repair or replacement of products found to be defective, and specifically excludes liability for incidental or consequential loss or damage.

11130

05-06 Mini Cooper S Hardtop without Rear Fog Light
05-08 Mini Cooper S Convertible without Rear Fog Light
07-09 Mini Cooper S Hardtop
2009 Mini Cooper S Convertible

Page 4 of 6

GROSS LOAD CAPACITY WHEN USED AS A WEIGHT CARRYING HITCH: 2,000 LBS. TRAILER WEIGHT & 200 LBS. TONGUE WEIGHT.

*****DO NOT EXCEED VEHICLE MANUFACTURER'S RECOMMENDED TOWING CAPACITY.*****

WARNING: ALL NON-TRAILER LOADS APPLIED TO THIS PRODUCT MUST BE SUPPORTED BY AUXILIARY STABILIZING STRAPS.

**** FAILURE TO PROPERLY SUPPORT NON-TRAILER LOADS WILL VOID PRODUCT WARRANTY****

HAVING INSTALLATION QUESTIONS? CALL TECHNICAL SUPPORT AT 1-800-798-0813

6. Remove the final two screws located at position 6 in Photo 2. These are the screws you see when you open your hatch.
If your vehicle is equipped with a rear fog light, disconnect the wiring harness from the back of the bumper cover and remove the light from the back side by depressing the tabs on each side of the light.
7. Pull up and back on the center of the bumper cover to release it from the center mount. Photo 5 shows the tab you are releasing behind the bumper cover.
8. Support the bumper cover. If you have backup sensors disconnect the wiring harness at this time. (Your bumper cover should be free from the car.)



Photo 5: Tab located at center of hatch under the bumper cover.

Hitch Installation:

Note: The hitch mounts between the vehicle's rear body panel and the factory bumper beam using the original bumper beam mounting bolts as shown in Photos 7 & 8.

1. Disconnect the wiring harness from the bumper beam by removing the (2) push fasteners on the top of the bumper beam.
2. Remove the bumper beam by removing the (8) M8 bolts holding the bumper beam to the vehicle. (See Photo 6) (Save the bolts and bumper beam for use in Step 3.)
3. Lift the hitch and bumper beam into position and secure them using the (8) M8 bolts (removed in Step 2) and the supplied conical toothed washers, as shown in Photos 7 and 8. **Note:** Trim foam behind bumper beam as needed for proper fit.
4. Torque all M8 hardware to 30 ft-lbs.
5. Reconnect the wiring harness to the bumper beam by reinstalling the push fasteners remove in Step 1.

PERIODICALLY CHECK THIS RECEIVER HITCH TO ENSURE THAT ALL FASTENERS ARE TIGHT AND THAT ALL STRUCTURAL COMPONENTS ARE SOUND.

Curt Manufacturing Inc., warrants this product to be free of defects in material and/or workmanship at the time of retail purchase by the original purchaser. If the product is found to be defective, Curt Manufacturing Inc., may repair or replace the product, at their option, when the product is returned, prepaid, with proof of purchase. Alteration to, misuse of, or improper installation of this product voids the warranty. Curt Manufacturing Inc.'s liability is limited to repair or replacement of products found to be defective, and specifically excludes liability for incidental or consequential loss or damage.

11130

05-06 Mini Cooper S Hardtop without Rear Fog Light
05-08 Mini Cooper S Convertible without Rear Fog Light
07-09 Mini Cooper S Hardtop
2009 Mini Cooper S Convertible

Page 5 of 6

GROSS LOAD CAPACITY WHEN USED AS A WEIGHT CARRYING HITCH: 2,000 LBS. TRAILER WEIGHT & 200 LBS. TONGUE WEIGHT.

*****DO NOT EXCEED VEHICLE MANUFACTURER'S RECOMMENDED TOWING CAPACITY.*****

WARNING: ALL NON-TRAILER LOADS APPLIED TO THIS PRODUCT MUST BE SUPPORTED BY AUXILIARY STABILIZING STRAPS.

**** FAILURE TO PROPERLY SUPPORT NON-TRAILER LOADS WILL VOID PRODUCT WARRANTY****

HAVING INSTALLATION QUESTIONS? CALL TECHNICAL SUPPORT AT 1-800-798-0813



Photo 6: Bumper beam removed.



Photo 7: Hitch in position.

Notes:

- On Mini Coopers with center exhaust the heat shield must be formed around the hitch to allow clearance. This can be done by simply pulling up on the end of the heat shield creating a divot. (See Photo 9)
- On the 2007+ Mini Cooper S, the rear valance will need to be modified, see trim detail. The rear valance is removed from the bumper cover by depressing the plastic fittings around the outside of the valance with a screwdriver and prying it apart. Reinstall the rear valance by connecting back into the plastic connectors.



Photo 8: Hitch and Bumper Beam Installed



Photo 9: Mini Cooper S

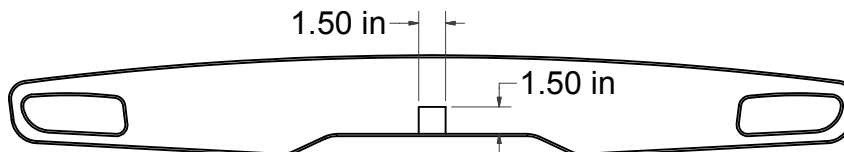

REAR VALANCE TRIM DETAIL

PERIODICALLY CHECK THIS RECEIVER HITCH TO ENSURE THAT ALL FASTENERS ARE TIGHT AND THAT ALL STRUCTURAL COMPONENTS ARE SOUND.

Curt Manufacturing Inc., warrants this product to be free of defects in material and/or workmanship at the time of retail purchase by the original purchaser. If the product is found to be defective, Curt Manufacturing Inc., may repair or replace the product, at their option, when the product is returned, prepaid, with proof of purchase. Alteration to, misuse of, or improper installation of this product voids the warranty. Curt Manufacturing Inc.'s liability is limited to repair or replacement of products found to be defective, and specifically excludes liability for incidental or consequential loss or damage.

11130

05-06 Mini Cooper S Hardtop without Rear Fog Light
05-08 Mini Cooper S Convertible without Rear Fog Light
07-09 Mini Cooper S Hardtop
2009 Mini Cooper S Convertible

Page 6 of 6

GROSS LOAD CAPACITY WHEN USED AS A WEIGHT CARRYING HITCH: 2,000 LBS. TRAILER WEIGHT & 200 LBS. TONGUE WEIGHT.

*****DO NOT EXCEED VEHICLE MANUFACTURER'S RECOMMENDED TOWING CAPACITY.*****

WARNING: ALL NON-TRAILER LOADS APPLIED TO THIS PRODUCT MUST BE SUPPORTED BY AUXILIARY STABILIZING STRAPS.

**** FAILURE TO PROPERLY SUPPORT NON-TRAILER LOADS WILL VOID PRODUCT WARRANTY****

HAVING INSTALLATION QUESTIONS? CALL TECHNICAL SUPPORT AT 1-800-798-0813

Reinstalling the Bumper Cover:

Notes:

- Refer to photos 1 - 4 while reinstalling the bumper cover.
- When hanging the bumper on the vehicle, there are three height locators for the bumper. (See Photos 10 and 11.) The bumper rests on the center alignment feature and fits between the (2) body and the side alignment features.
- 1. If removed, reattach the wiring harness for the back up sensors.
- 2. Install the (2) screws inside the hatch opening. (Only tighten about two-thirds of the way, this will allow some adjustment for alignment of the bumper cover with the vehicle.)
- 3. Tighten the (2) fasteners inside the rear body flairs. When complete, reattach the fender flare to the rear bumper and reinstall fasteners behind the wheel well liner.
- 4. Secure the inner fender well liner to the body using the (4) phillips head push fasteners.
- 5. Tighten the two phillips head screws inside the hatch opening.
- 6. Tighten the washer head hex screw in the bottom of the bumper cover.



Photo 10: Side alignment feature.



Photo 11: Center alignment feature.



Photo 12: Hitch shown installed with safety chains

PERIODICALLY CHECK THIS RECEIVER HITCH TO ENSURE THAT ALL FASTENERS ARE TIGHT AND THAT ALL STRUCTURAL COMPONENTS ARE SOUND.

Curt Manufacturing Inc., warrants this product to be free of defects in material and/or workmanship at the time of retail purchase by the original purchaser. If the product is found to be defective, Curt Manufacturing Inc., may repair or replace the product, at their option, when the product is returned, prepaid, with proof of purchase. Alteration to, misuse of, or improper installation of this product voids the warranty. Curt Manufacturing Inc.'s liability is limited to repair or replacement of products found to be defective, and specifically excludes liability for incidental or consequential loss or damage.