

GROSS LOAD CAPACITY WHEN USED AS A WEIGHT CARRYING HITCH: 2,000 LBS. TRAILER WEIGHT & 200 LBS. TONGUE WEIGHT.

*****DO NOT EXCEED VEHICLE MANUFACTURER'S RECOMMENDED TOWING CAPACITY.*****

WARNING: ALL NON-TRAILER LOADS APPLIED TO THIS PRODUCT MUST BE SUPPORTED BY AUXILIARY STABILIZING STRAPS.

**** FAILURE TO PROPERLY SUPPORT NON-TRAILER LOADS WILL VOID PRODUCT WARRANTY****

HAVING INSTALLATION QUESTIONS? CALL TECHNICAL SUPPORT AT 1-800-798-0813

Parts List			
ITEM	QTY	PART NUMBER	DESCRIPTION
1	2	7/16-14 x 2 1/2	CARRIAGE BOLT
2	2	CM-SP2	.250 x .88 x 2.25" SQ. HOLE SPACER
3	4	7/16-14	HEX FLANGE NUT
4	1	7_16 - 14 x 1.75" x 1.00" C-C	U-BOLT
5	2	7_16 FISHWIRE	7/16" FISHWIRE

TOOLS REQUIRED
FLAT SCREWDRIVER
PHILLIPS SCREWDRIVER
10mm AND 3/4" SOCKETS
12" EXTENSION
RATCHET
TORQUE WRENCH
ROTARY CUTTING TOOL

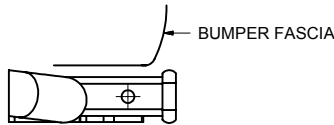

INSTALLED HITCH POSITION

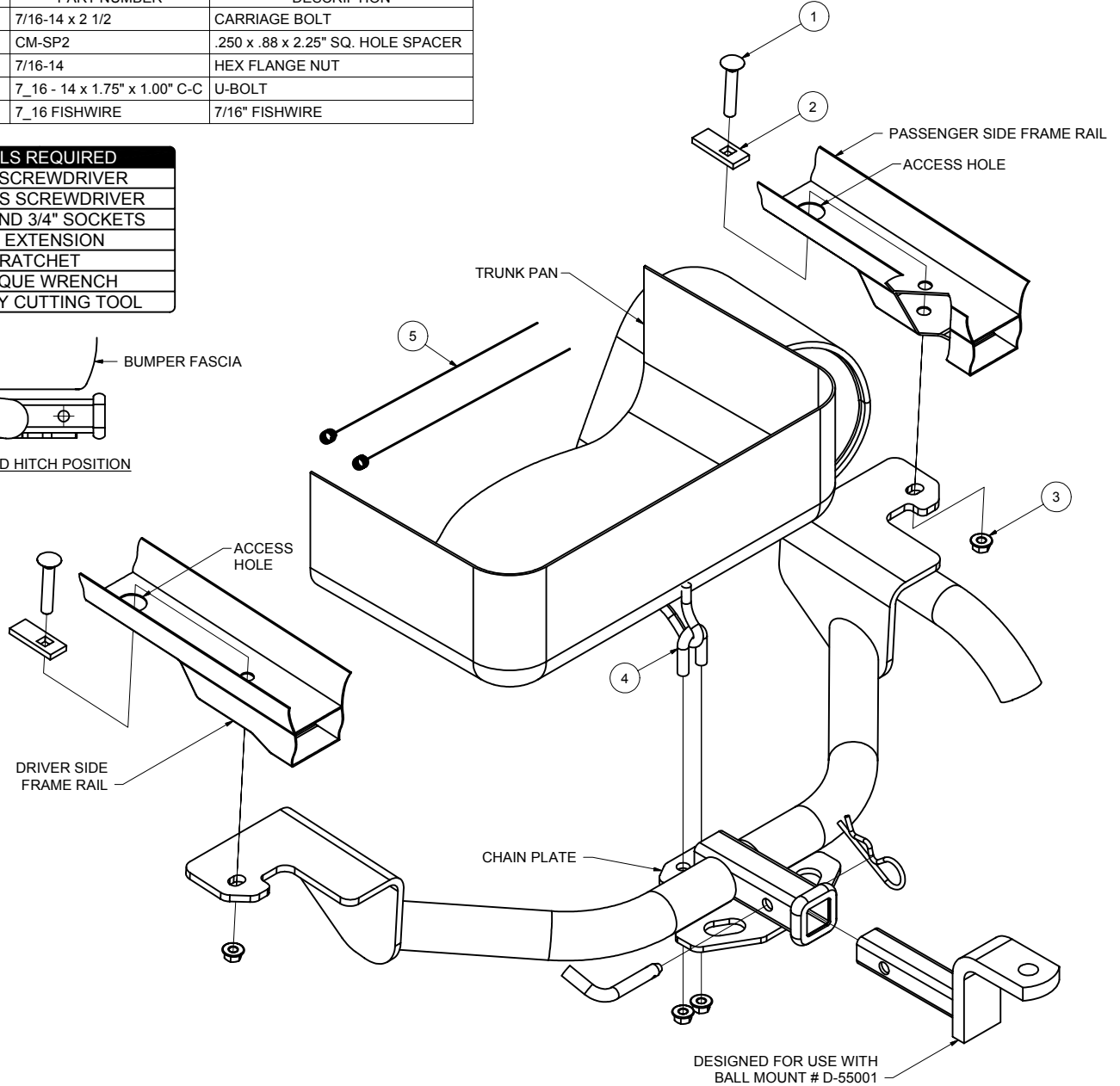

- HITCH WEIGHT: 25 LBS.
 INSTALL TIME: 45 MINUTES
 INSTALL NOTES:
 - NO DRILLING REQUIRED
 - LOWER EXHAUST
 - FISHWIRE HARDWARE
 - TRIM SPLASH SHIELDS

PERIODICALLY CHECK THIS RECEIVER HITCH TO ENSURE THAT ALL FASTENERS ARE TIGHT AND THAT ALL STRUCTURAL COMPONENTS ARE SOUND.

Curt Manufacturing Inc., warrants this product to be free of defects in material and/or workmanship at the time of retail purchase by the original purchaser. If the product is found to be defective, Curt Manufacturing Inc., may repair or replace the product, at their option, when the product is returned, prepaid, with proof of purchase. Alteration to, misuse of, or improper installation of this product voids the warranty. Curt Manufacturing Inc.'s liability is limited to repair or replacement of products found to be defective, and specifically excludes liability for incidental or consequential loss or damage.

*****DO NOT EXCEED VEHICLE MANUFACTURER'S RECOMMENDED TOWING CAPACITY.*****

WARNING: ALL NON-TRAILER LOADS APPLIED TO THIS PRODUCT MUST BE SUPPORTED BY AUXILIARY STABILIZING STRAPS.

**** FAILURE TO PROPERLY SUPPORT NON-TRAILER LOADS WILL VOID PRODUCT WARRANTY****

HAVING INSTALLATION QUESTIONS? CALL TECHNICAL SUPPORT AT 1-800-798-0813

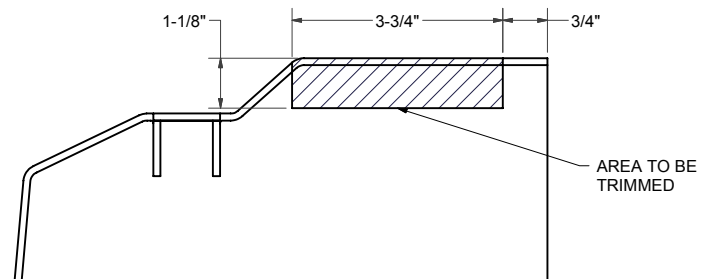
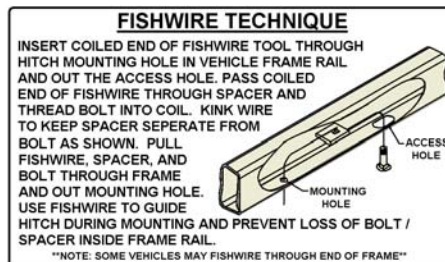
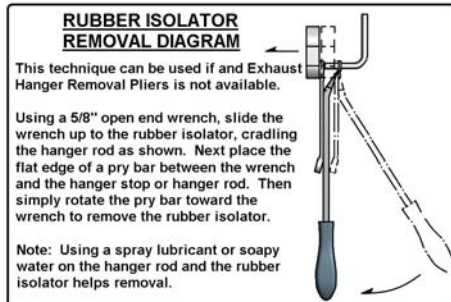

SPLASH SHIELD TRIMMING

INSTALLATIONS STEPS:

1. Lower the exhaust by removing the (2) rubber isolators from the hangers. (See Rubber Isolator Removal.)
 2. Remove the (2) bolts retaining the evaporative emissions canister and allow it to hang. (See photo above.)
 3. Remove the splash shields located in the rear wheel wells by removing the (3) screws and (3) push fasteners securing them.
 4. Fishwire a 7/16-14 x 2-1/2" carriage bolt and CM-SP2 spacer through the access holes in the frame rails and into the rearmost holes in the frame rails as shown. (See Fishwire Technique.)
- Also, hang the U-bolt through the tow loop at this time.
5. Raise the hitch into position and secure it to the tow loop using the u-bolt and (2) 7/16" hex flange nuts through the chain plate as shown. Take care not to push the fishwired carriage bolts back into the frame rails.
 6. Position the side plates against the frame rails over the 7/16" carriage bolts and secure using 7/16" hex flange nuts as shown.
 7. Torque all 7/16" hardware to 50 ft-lbs.
 8. Raise the exhaust back into position and reinstall the rubber isolators.
 9. Trim the splash shields and reinstall. (See Splash Shield Trimming.)
 10. Reinstall the evaporative emissions canister.

PERIODICALLY CHECK THIS RECEIVER HITCH TO ENSURE THAT ALL FASTENERS ARE TIGHT AND THAT ALL STRUCTURAL COMPONENTS ARE SOUND.